

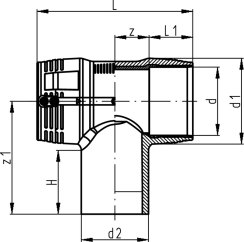

Tee 90° equal

- PE 100 SDR 11 (ISO S5)
- 10 bar Gas / 16 bar Water
- 4 mm pin connectors
- Limited path fusion indicators



d (mm)	Code	SP	Weight (kg)	d1 (mm)	L (mm)	L1 (mm)	z (mm)	z1 (mm)	H (mm)
75	753 211 612	1	0.569	97	178	54	35	143	87
90	753 201 813	1	0.891	115	205	62	41	161	94
110	753 201 814	1	1.576	140	255	72	56	184	104
125	753 201 815	1	2.212	161	276	78	60	207	113
160	753 201 817	1	4.386	196	325	92	71	206	103
180	753 201 818	1	6.796	225	344	90	82	250	110

The technical data are not binding. They neither constitute expressly warranted characteristics nor guaranteed properties nor a guaranteed durability. They are subject to modification. Our General Terms of Sale apply.

Georg Fischer Piping Systems Ltd, Postfach, CH-8201 Schaffhausen/Switzerland

Phone +41 -(0)52-631 1111

e-mail: info.ps@georgfischer.com

Internet: <http://www.gfps.com>